

# AlphaTrak3

## BLOOD GLUCOSE MONITORING SYSTEM



### Bluetooth® Setup Guide

#### 1. Enable discovery mode on your meter



Press **m** for less than 3 sec to turn on your meter.



Press **m** again for less than 3 sec to view result history.



Press and hold both **m** and **c** together for 3 sec to toggle Bluetooth® discovery mode.

⚡ will appear blinking on the screen.

#### 2. Pair on your mobile

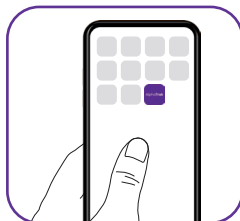

Open the **AlphaTrak** application.

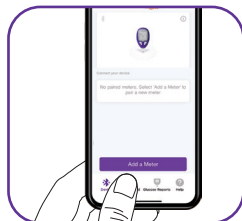

Tap **Device** at the bottom navigation. Tap **Add a Meter** to find your meter.

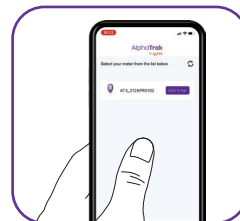

Tap **⚡** if you don't automatically find your meter. Select your meter and tap **Click to Pair**.

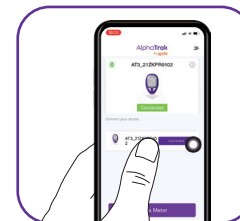

Application will confirm that you've successfully connected. On the meter, the Bluetooth® icon will stop blinking.

#### 3. Import test data

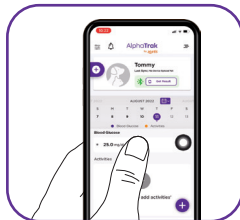

Tap **Dashboard** at the bottom navigation.



Tap **Get Result** to fetch test results from your meter.

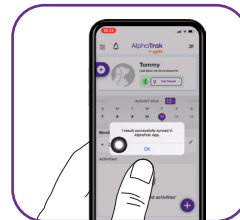

Application will confirm that test results successfully synced.

When getting test results, if the Bluetooth® mode is set to turn on automatically, you will see the blinking Bluetooth® icon once the result is ready. This indicates that Bluetooth® is on and ready to pair with the AlphaTrak App.